

3 1/16"

SURFACE AND EDGE PLANE INDUSTRIAL DUTY

MODEL
TPC-8937A

WARDS
POWER-KRAFT

owner's
guide and
PARTS LIST

Form #84P-181*

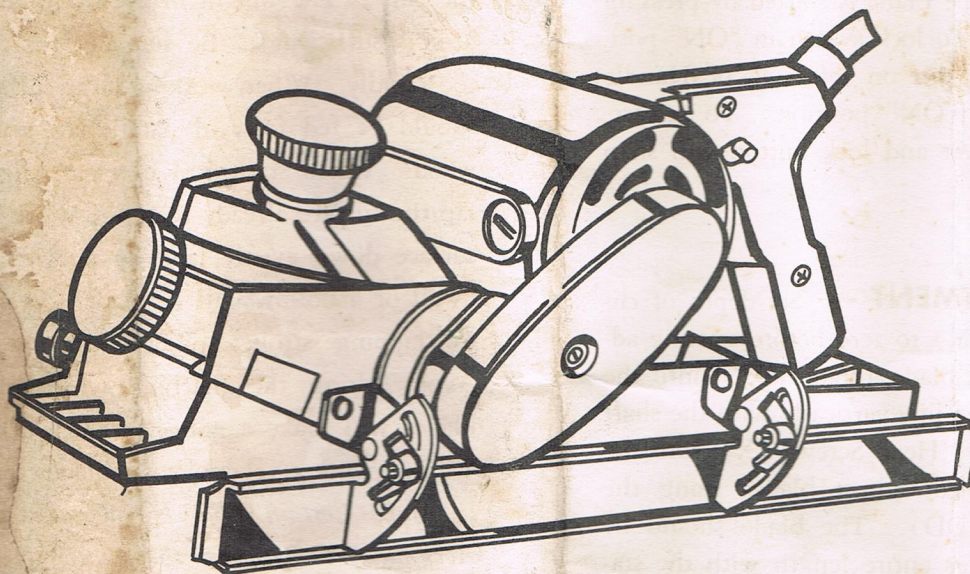

**DESIGNED FOR BUILDERS, CARPENTERS, PATTERN SHOPS, CABINET MAKERS,
'AND WOOD WORKING INDUSTRIES.**

DeLuxe Features . . .

- 100% ball bearing construction.
- Develops 3/4 horsepower — 7.0 amps U/L Industrial Rated.
- Bevel fence adjusts 0° to 45°; fits either side.
- Depth of cut 0 in. to 1/8 in.
- External brushes for quick brush inspection.
- Heavy-duty 10 ft. cord with large strain relief to keep cord away from working surface.
- Exclusive shoe guides plane for planing corners or edge of wood.
- Built in chip deflector.
- Dynamically balanced armature.

* Be sure to read this Owner's Guide thoroughly before using your Plane.

POWER-KRAFT — SOLD EXCLUSIVELY BY **MONTGOMERY WARD**

OPERATING INSTRUCTIONS

MOTOR — Your Powr-Kraft Plane operates on alternating current (AC) only. Plug cord into any 115 volt 25/60 cycle outlet. Always pick up your Plane before pulling the switch.

SWITCH — The Plane is started by pressing the Switch lever. To lock switch in "ON" position, press lock button on left side of Handle while switch is in "ON" position. To release, press on switch lever and lock button will snap out.

BLADE ADJUSTMENT — Set depth of cut adjustment knob (M) to zero before starting adjustment. To adjust blade, rotate holder until the tip of the blade is in line vertically with the shaft center. Loosen Hex Head Screws (X) with the "T" wrench supplied; adjust blades using the adjusting screws (DD). The blade should be set to be level in its entire length with the stationary rear platen of the plane; this can be accomplished by using the triangular gauge supplied with your Powr-Kraft Plane (See Fig. 1) Tighten the Hex Head Screws (X). Repeat adjustment for second blade.

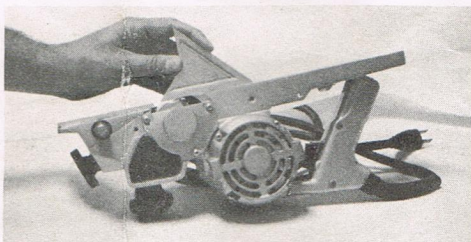

Fig. 1

DEPTH OF CUT ADJUSTMENT — The depth of cut is adjustable from 0° to 1/8". To make adjustment, turn foot adjustment knob (M) to desired depth as indicated on marker on side. NOTE: FOR SURFACE PLANING, REMOVE SIDE PLATE (WX).

With one hand holding front handle (K) and other hand holding switch handle (RS) place front shoe on work making certain blades are not touching the work. Put pressure on front

handle (K) so that the front shoe is absolutely flat on the work. Start Plane. With motor running full speed, push plane forward. After cutting begins, transfer weight to rear switch handle (RS) and keep weight there throughout the cut. (The weight of the machine and your arm is sufficient). Be sure not to force Plane too rapidly. When working large surfaces, plane should be fed forward parallel to grain of the wood. When starting a new cut, slightly overlap the surface already planed. Work the whole surface down evenly, and do not let the plane dwell or a hollow will be made. Evenly spaced overlapping strokes produce the best results. Avoid tilting the machine when planing, as blades will make a gouge in the work. While planing, check your blades periodically to *Make Certain That No Wood Chips Have Accumulated Between the Cutter Head, Blade and Blade Binder*. This may be avoided if Hex Head Screws (X) are tightened properly, blade adjusted properly, and the preceding instructions followed.

INSTALLATION OF SIDE PLATE ASSEMBLY

— The Side Plate is specifically used when planing edges. To install the Side Plate lay Plane on the side which you wish to install Side Plate. Place Side Plate on unit lining up the two holes on the side plate with the two holes on the casting. Put two screws (BB) in holes and tighten.

For placing Side Plate on the side which houses the rabbetting attachment (T), remove rabbetting attachment and reverse above procedure. On the right side of the tool the long end of the Side Plate must be forward.

SIDE PLATE ASSEMBLY — Removable side plate can be made adjustable for right or left bevel cuts from 0° to 45° and generally is used for door and sash work. Side plate is removed easily for surface planing. The side plate helps to plane long and uneven surfaces accurately.

RABBETTING — Rabbetting is used in cabinet making, for shevles, drawers, corners, and doors. On the adjusting foot a precision machined 90° slot has been machined out on the right side of the unit. The depth of cut for rabbetting may be from 0 to minus 1/16" or greater if preferred. A greater depth may be accomplished by using depth of cut scale from 0° to 1/8".

The cutter blades must be adjusted to a height higher than the rear platen (approximately 1/64" or level with the platen). Adjust front shoe to the depth desired.

Before starting on good lumber make a few cuts on a piece of scrap lumber to determine the desired depth. With one hand holding front handle and the other hand holding switch handle, place the front shoe on the work making certain that the edge of the wood is in the machined slot of said shoe and the rabbetting attachment is resting on the wood. This attachment is a means of levelling the machine. Start Plane. With motor running full speed, push plane forward. See Fig. 2.

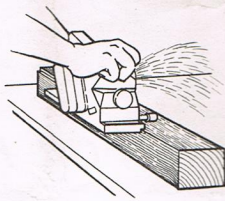

Fig. 2

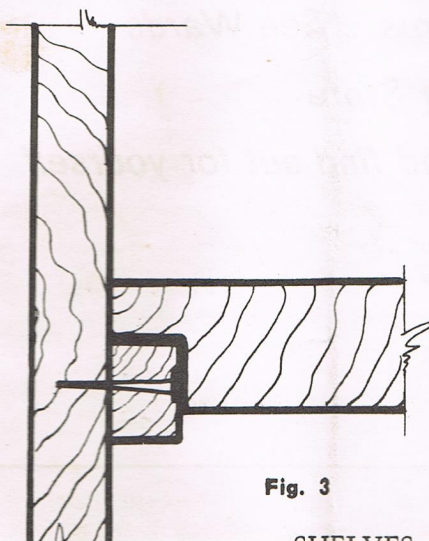

Fig. 3

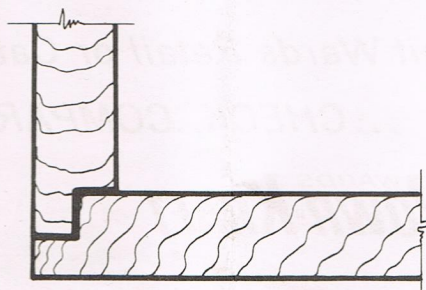

Fig. 4

CORNERS
CABINET & TABLE TOPS
FLUSH DRAWERS

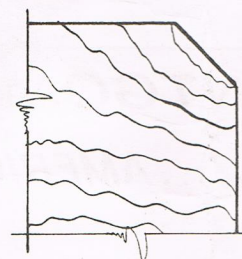

Fig. 6

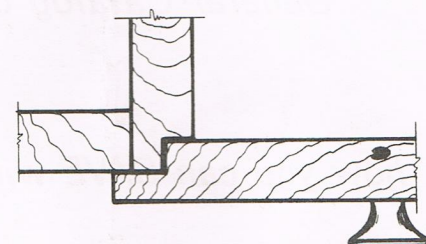

Fig. 5

NON FLUSH DRAWERS
DOORS

For rabbetting pieces of wood that are too narrow to use the rabbetting attachment, take a 2x4 and secure it to the side of the wood you are about to rabbet. (Make certain that the 2x4 is parallel to the top of the wood and opposite the side or corner to be rabbetted. Work may be produced as shown below if instructions are followed. See Figs. 3, 4 and 5.

CHAMFERING OR EDGE PLANING —

Your POWR-KAFT PLANE has a precision machined groove in the middle of the FRONT ADJUSTING SHOE. The purpose of this groove is to chamfer the corners of your work. See fig. 6.

Before starting on good lumber make a few cuts on a piece of scrap lumber to determine the desired depth. When starting your chamfering on good lumber be sure that the front shoe and blades are adjusted properly. When chamfering move the plane slowly along the corner of the wood (do not force the Plane or move too fast because the Plane may slip causing an irregular chamfer).

CUTTER BLADES — The cutter blades in your Powr-Kraft Plane are made from High Speed Tempered Steel, hardened and precision honed. If not abused, they will stay sharp for many hours of use. For good results, the blades **MUST BE SHARP**. Extra blades may be purchased from your nearest Montgomery Ward retail store, catalog store, or mail order house.

CHANGING CUTTER BLADES —

1. Be sure to disconnect cord before changing or adjusting blades.
2. Remove side plate.
3. Remove hex head screws (X).
4. Remove blade binder (UV).
5. Remove blade (VW).
6. Insert new blades making certain that the screws on the blade are down securely and on the same side as the chamfer on the blade. See fig. 7.
7. Place blade on the cutter head, make certain that the two screws are seated properly in cutter head.
8. Replace blade binder and Hex Head Screws (X).

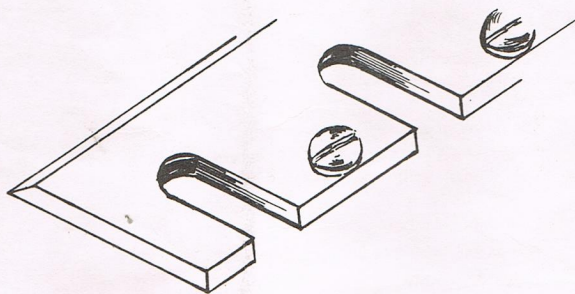

Fig. 7

ELECTRIC CONNECTION, POWER LINE

For your protection this tool is equipped with Underwriters Laboratories approved three prong plug. When this plug is inserted into properly grounded receptacle, it will guard the user against shock if the tool insulation should fail for any reason.

To connect this plug to a standard 2-pole, parallel-slot receptacle an adapter is required to accept the 3 prongs. See illustration. It is recommended that the conventional two-prong receptacle be replaced with a listed three-prong receptacle at convenience outlets where heavy duty appliances are connected. The adapter is intended only as a temporary expedient until receptacles are replaced.

CAUTION: Before using the Adapter, make sure the convenience outlet box you intend to use is properly and effectively grounded. If there is any doubt, consult an electrician.

MAINTENANCE — A periodic maintenance and cleaning program is recommended to keep your Powr-Kraft TPC 8937A in top condition. After 100 hours of use the Plane should be checked and cleaned as follows.

TIMING BELT —

1. Remove screw (J) and Pulley cover (H).
2. Rotate and slide drive belts (G) off small drive pulley (F).
3. Inspect, if worn excessively replace.
4. Clean out all dust and wood chips from this area.

BRUSHES —

1. Check the motor Brushes two or three times a year.
2. Unscrew Brush Caps (X).
3. Inspect Brushes (V) and if worn to within 5/16" of pigtail end, replace.
4. If brushes are not being replaced be careful to return brushes to their original position.
5. If brush replacement is necessary they may be purchased from your nearest Montgomery Wards Retail Store, Catalog Store or Mail Order House.

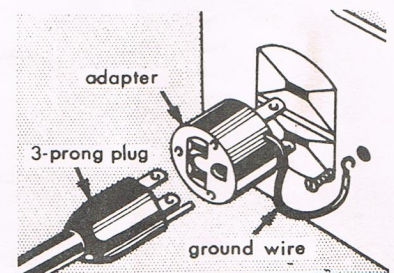

Important: Connect the terminal on the ground wire of the Adapter to the face plate mounting screw of the receptacle. (This connects the third prong to the grounded box.) Insert the two prongs of the Adapter into the receptacle. The new 3-prong attachment plug on the supply cord of your tool can now be inserted into the Adapter and your tool is ready for use.

POWR-KRAFT 3-1/16" PLANE

MODEL TPC-8937A

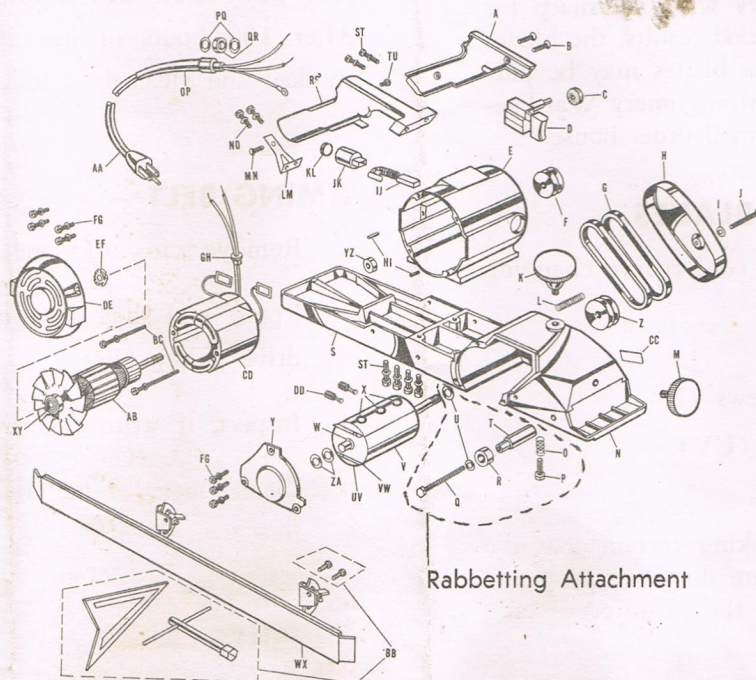

Rabbetting Attachment

Ref. Ltr.	NAME OF PART	Part Number	Ref. Ltr.	NAME OF PART	Part Number
A	Cover Half, Handle	75-42MS	CC	"Metal-Cal" — "Depth of Cut"	75-86
B	Screw, #8-32x3/4" Lg. Phil. Oval Head, Steel Cad. Plate	75-32	AB	Armature Assembly	7-125
C	Pad, Rubber (Switch Retainer)	28-82	BC	Screw, #10-24x1 3/4" Lg. Phil. Pan Head w/Sems Split Lock Washer Steel Cad Plate	75-34
D	Switch	18-129	CD	Field Assembly	8-104
E	Motor Housing Assembly (Includes One (1) 10-20 Ball Bearing)	75-66MS	DE	Cover, Motor Housing	75-44MS
F	Pulley, Armature Shaft	75-82	EF	Spring Washers	75-69
G	Belt, Drive Pulley	75-1	FG	Screw, #8-32x1/4" Lg. Phil. Pan. Head w/Sems Split Lock Washer Steel Cad. Plate	75-33
H	Stamping Pulley Cover	75-85	GH	Grommet, Rubber	75-12
I	Washer, Steel	75-76	HI	Screw Set, #10-24x.200 Lg. Cup Point	75-40
J	Screw, #8-32x1 1/2" Lg. Phil. Pan Head Steel Cad. Plate	75-75	IJ	Brush Assembly	75-4
K	Auxiliary Handle (Black)	75-84	JK	Brushholder	75-5
L	Compression Spring	75-67	KL	Brush Cap	75-57
M	Foot, Adjustment Screw Assembly	75-70	LM	Handle Bracket	75-50
N	Casting, Foot Adjusting	75-64MS	MN	Screw, #1/4"-20x3/8" Lg. Phil. Flat Head Steel	75-41
O	Compression Spring	75-68	NO	Screw, #10-24x3/8" Lg. Phil. Pan. Head w/Sems Split Lock Washer, Steel Cad. Plate	75-30
P	Screw, #1/4-20x3/8" Lg. Hex Head Steel Cad. Plate	75-73	OP	Strain Relief	75-28
Q	Screw, #1/4-20x2" Lg. Hex Head Steel Cad. Plate	75-74	PQ	Washer, Fibre (Strain Relief)	75-58
R	Rabbetting Guide Roller	75-81	QR	Washer, Rubber (Strain Relief)	75-29
S	Supporting Half Assembly (Includes One (1) 10-20 Ball Bearing)	75-65	RS	Supporting Half, Handle	75-43MS
T	Rabbetting Extension	75-80	ST	Screw, #10-24x5/8" Lg. Phil. Pan. Head w/Sems Split Lock Washer, Steel Cad. Plate	75-31
V	Cutter Head Assembly	75-62	TU	Ground Screw	22-594
W	Washer, Brass (Cutter Head Assembly)	75-78	UV	Blade, Binders	75-60
X	Screw, #1/4-20x1 1/2" Lg. Hex Head Steel Cad. Plate	75-72	VW	Blade, Planer	75-61
Y	Cutter Head Support Assembly Includes one (1) 10-20 Ball Bearing)	75-63	WX	Side Plate Assembly	75-210
Z	Pulley, Cutter Head	75-83	XY	Ball Bearing	75-3
AA	Cord Set	11-138	YZ	Spacer, Brass (Armature Shaft)	75-79
BB	Accessory Package, Consisting of 1—Screw 10-24x3/8" Lg.; 1—Screw 8-32x3/8" Lg.; 1—"T" Wrench; 1—Side Plate	75-8	ZA	Washer, Steel (Cutter Assembly)	75-77
			DD	Screw, Blade Adjustment	75-71

HOW TO OBTAIN SERVICE



The merchandise you have purchased from us has been carefully engineered and manufactured under Wards rigid quality standards and should give you satisfactory and dependable operation. However, like all mechanical merchandise, it may occasionally require adjustment or maintenance. Should you ever need technical assistance, please contact or write your nearest Wards Retail Store, Catalog Store or Catalog House.

Provide the following:

1. Model, serial number and all of the other data shown on the model plate.
2. The date and the Wards branch from which you purchased your merchandise.
3. State briefly the trouble you are having.

HOW TO OBTAIN REPLACEMENT PARTS



Replacement Parts may be obtained from your Wards Retail Store, Catalog Store or Catalog House and will be made available at current prices. If requested, prices will be quoted in advance when not listed.

When requesting replacement parts, be sure to give the model and serial number which is shown on the model plate. Also give the part number and the name of the part as shown in the parts list.

If you order by mail, you will pay the transportation charges from the shipping point.

WARRANTY

Wards will repair or replace free, at our option, any Powr-Kraft electric portable power tool which fails and is returned to us within one year of purchase. This guarantee does not cover damage due to abuse or to use of improper voltage. Tools used in the rental service are excluded.

SHOP MONTGOMERY WARD

...AMERICA'S HEADQUARTERS FOR FINE TOOLS

Choose from a wide selection of high quality attachments,

accessories, tools, and hardware items... See Wards

General Catalog or visit Wards Retail or Catalog Store

...CHECK, COMPARE and find out for yourself

how you can SAVE with **WARDS
POWR-KRAFT**

POWR-KRAFT — SOLD EXCLUSIVELY BY MONTGOMERY WARD

41-1621 8/68